



# Ceco Stone

— Lightweight Recycled Architectural Components —



McMILLAN & HOLDER

# Ceco Stone

**An innovative new addition to both traditional and modern architecture.** Brought to you by McMillan & Holder, Ceco stone has been created using recycled materials, making it environmentally friendly and cost effective.

**Ceco Stone is a ceramic based material that imitates stone faithfully.** It can be used alongside or in place of natural stone as a light-weight, non-structural alternative. Yet unlike other materials Ceco Stone is made entirely from 85 percent recycled waste with the remaining 15 percent being only additional sand. Unlike any of the stone alternatives on the market, Ceco stone is not only recycled, but can be recycled again at the end of its life, to eliminate future waste.

**Ceco Stone is a revolutionary solution to architectural design.** It has been developed primarily for architectural ornament, and has enormous potential for use in commercial development, commercial and domestic house building, modern architecture or DIY projects. It has density which offers the feel of cast stone, but has the lightweight properties of EPS, GFRC, and GFP.

It is affordable, durable, and more like natural stone than any of its competitors, with the ability for on-site alterations and pairing in. It is a superior product suitable anywhere, in any design



# Strengths



## Waterproof

Ceco Stone is essentially a porcelain foam fired at extremely high temperatures. Like porcelain, its water absorption is below 0.5%



## Fire Resistant

Ceco Stone is essentially inert to fire, and has a fire rating of A1. (EN 13501-1:2018)



## Frost Proof

Ceco Stone has an outstanding freeze and thaw performance, partly due to the fact that it is completely impervious to weather.



## Thermal Insulation

Ceco Stone acts as a perfect insulator, and has a thermal performance of 0.15 w/mk.



## Strong & Durable

EU and UK laboratory test data, places Ceco Stone alongside a mid-range concrete for Tensile and Compressive Strengths: 846 N / 5 MPa.

It's homogeneous colour means that unlike any of its cast stone, Gfc, Gfp or EPS alternatives, aging/weathering will not expose a non-conforming substructure and consequently will never need to be patched or painted.



## No Cracking

Cast stone, as it cures, shrinks slightly, as water is both used up in the Cast stone curing reactions, and also evaporates in the atmosphere. Ceco Stone is fired at 1500 degrees and consequently has a shrinkage value of 0.1.



## Eco Friendly

Ceco Stone is made from **85% recycled materials**. Taking waste from the ceramics industry, discarded mining matter and glass waste.

Ceco stone has the same life span as the building, and 100 years from now, it is the only construction product that can be completely recycled back into a new component.



## Cost Effective

While Ceco Stone has been designed to be visually identical to natural stone, it is **80% more cost effective**, while also as much as 50% cheaper than cast stone competitors.

This allows our clients to use it on its own or in partnership with natural stone to bring every project in, on budget, no matter how ambitious.



## Lightweight

**Ceco Stone is 20% the weight of natural stone or concrete cast**. This takes the stress load off the structure and the stress out of the installation. One operative can safely handle/carry, large components that would be impossible in cast stone or natural stone. The efficiency savings in the installation process are considerable as the product can be handled/carried, glued, strapped or pinned, avoiding all the costly traditional installation imperatives.



## Easily Modified

Ceco Stone is the only product that has **no lead time if anything is damaged on site**. The operative can simply take a spare section and instantly make a new component (as with wood). It is the only product that can be trimmed and perfected on site, without exposing a non-conforming sub-structure. There is no set time, or paint and dry time. It is instant.

# Product Overview

We now provide most of the stone components that you will find on in classical architecture in Ceco Stone.



PEDIMENTS



CORNICE



CILLS



STRING COURSE



PARAPET SCREENING



QUOINS



HEADS



BALUSTRADE



GATES & ENTRANCES



COPING & CAPPING

# DOOR SURROUNDS

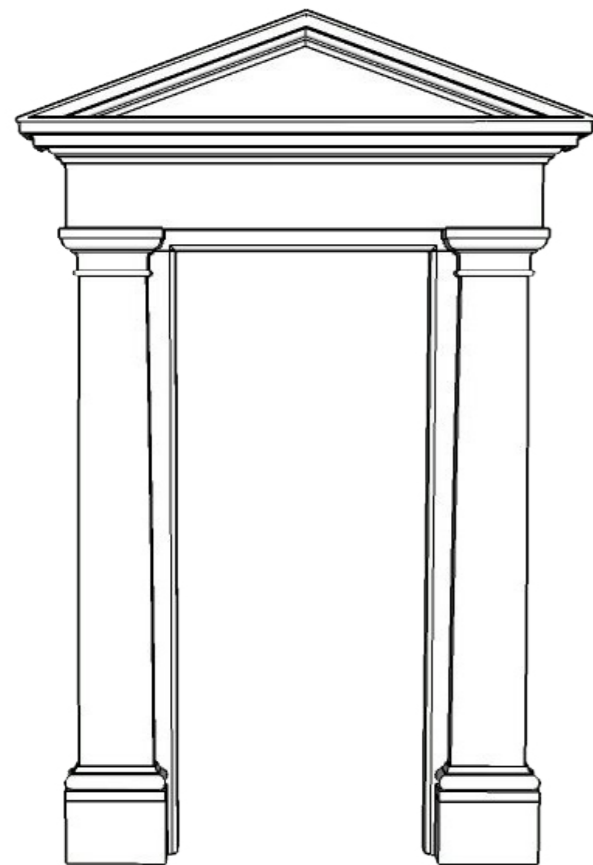

PEDIMENT DOOR SURROUND

LENGTH - 2308 mm

HEIGHT - 3120 mm



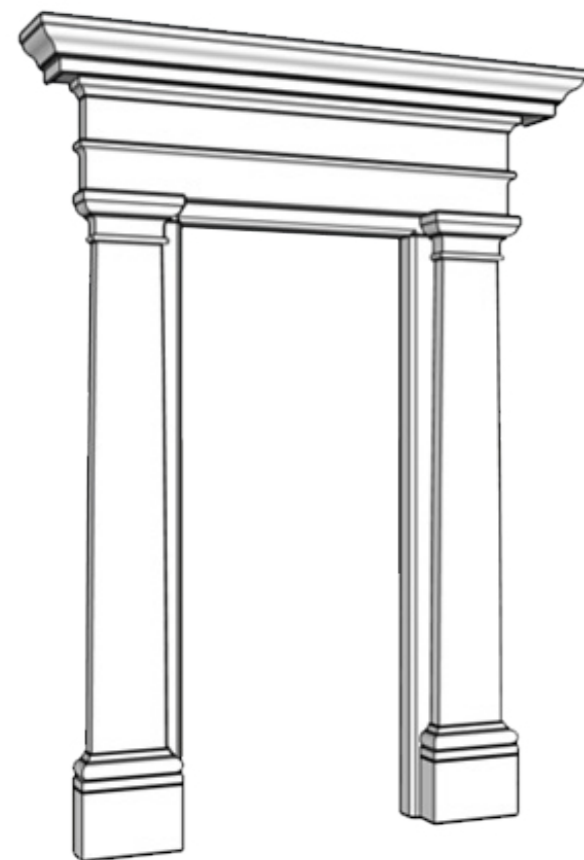

## CORNICE DOOR SURROUND

LENGTH - 2308 mm

HEIGHT - 3120 mm

## INTERNAL DOOR SURROUND

LENGTH - 1410 mm

HEIGHT - 2640 mm



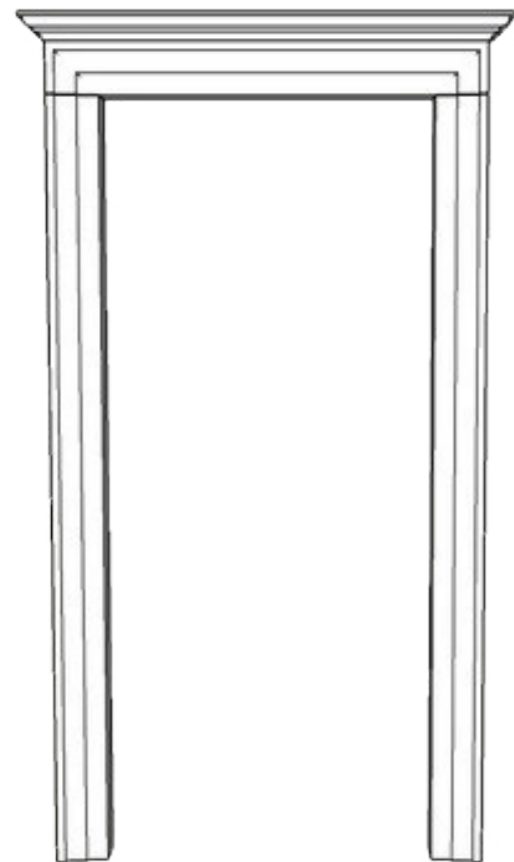

STEPPED ARCHITRAVE  
WITH CORNICE DOOR SURROUND

LENGTH - 1180 mm

HEIGHT - 2350 mm



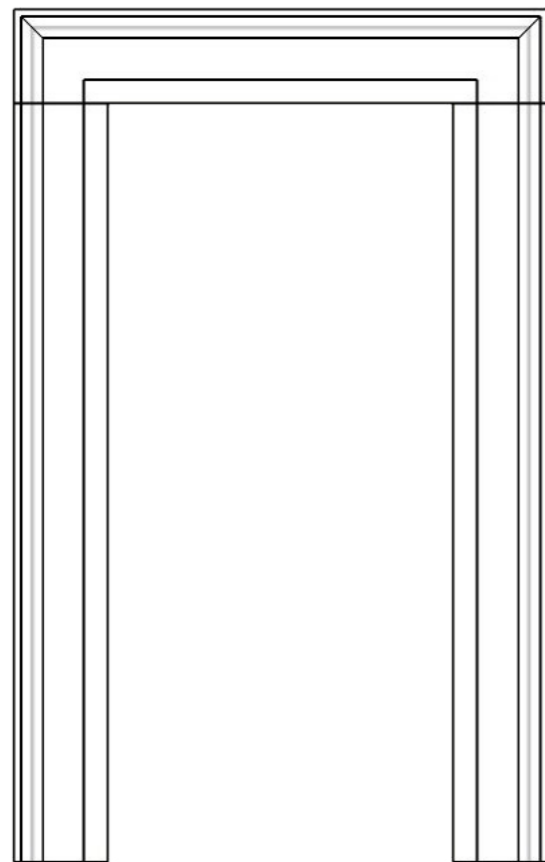

## STEPPED ARCHITRAVE DOOR SURROUND

LENGTH - 1550 mm

HEIGHT - 2475 mm



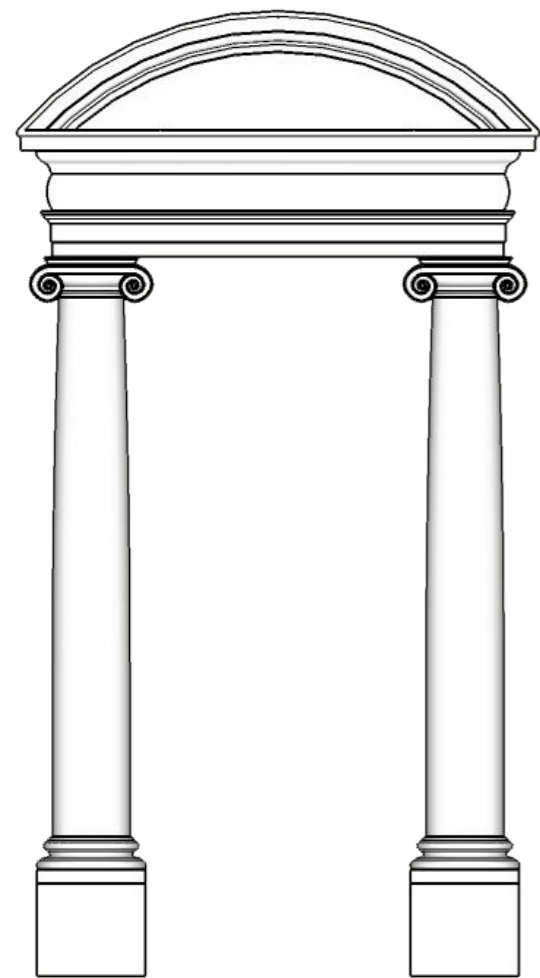

## IONIC DOOR SURROUND

LENGTH - 1610 mm

HEIGHT - 2975 mm



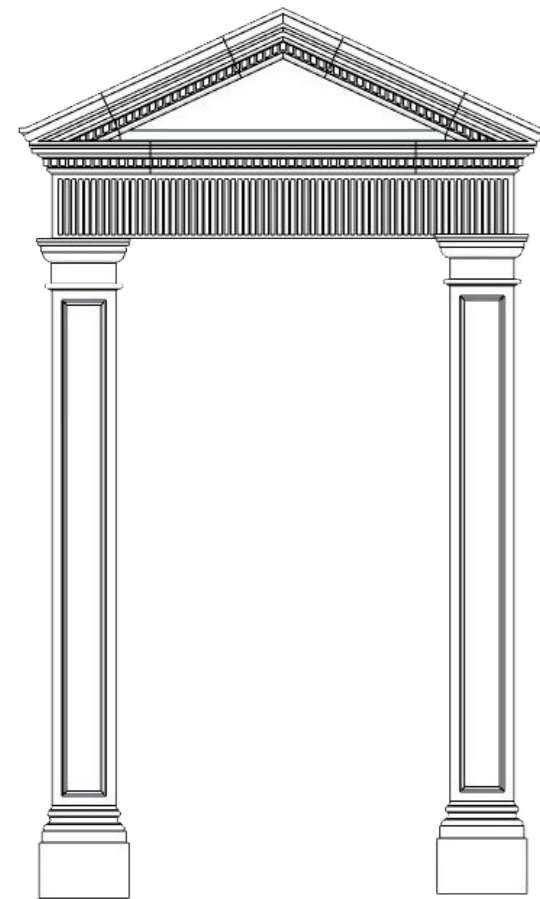

## BESPOKE DOOR SURROUND

LENGTH - 2175 mm

HEIGHT - 3675 mm





## DOOR CANOPY

LENGTH - 1500 mm

PROJECTION - 665 mm

HEIGHT - 550 mm

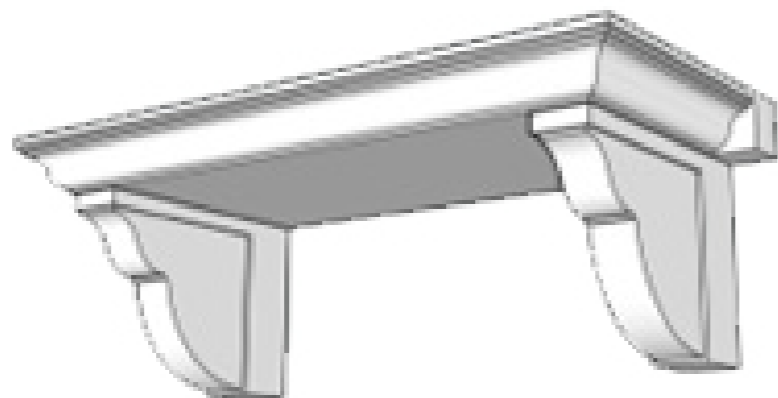

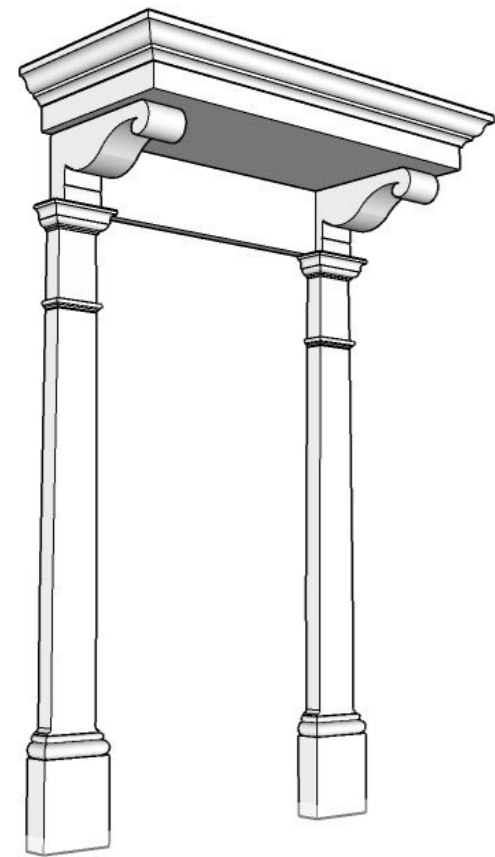

## PILLASTERED DOOR CANOPY

LENGTH - 1710 mm

PROJECTION - 880 mm

HIEGHT- 3030 mm



# WINDOW SURROUNDS

---

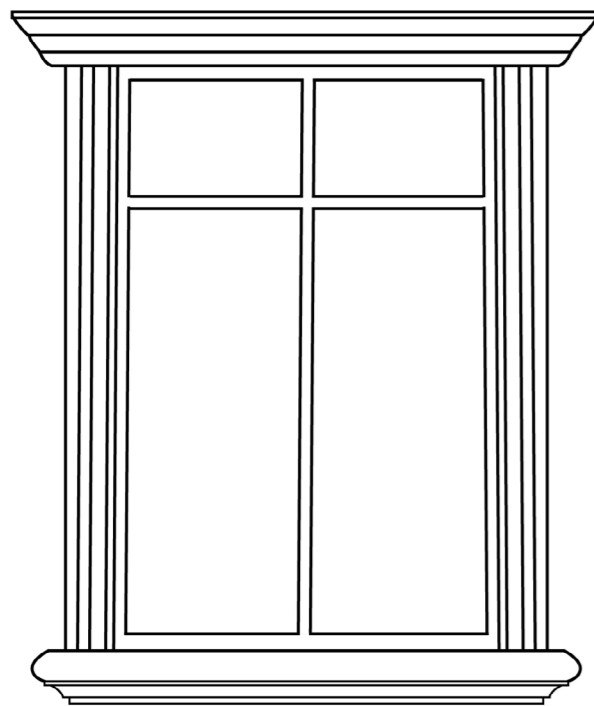

WINDOW SURROUND  
WITH CORNICE

---

LENGTH - 1320 mm

HEIGHT - 2045 mm



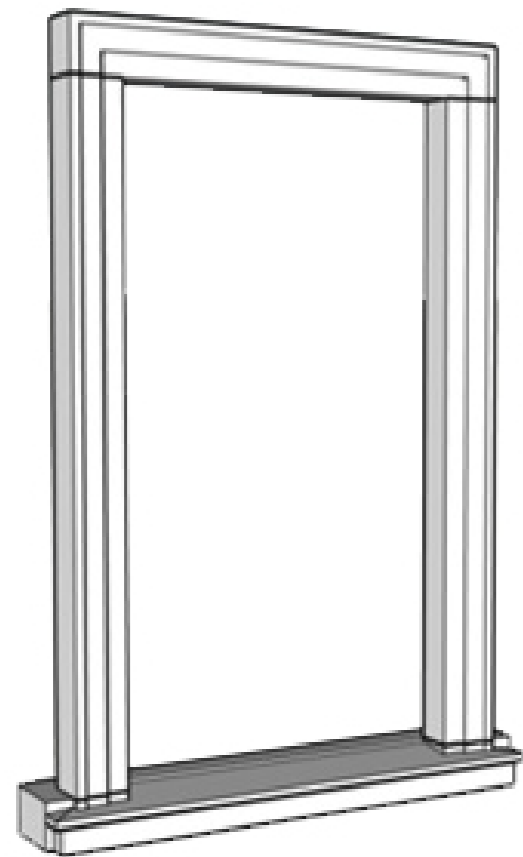

SQUARE HEAD  
WINDOW SURROUND

---

LENGTH - 1960 mm

HEIGHT - 1320 mm



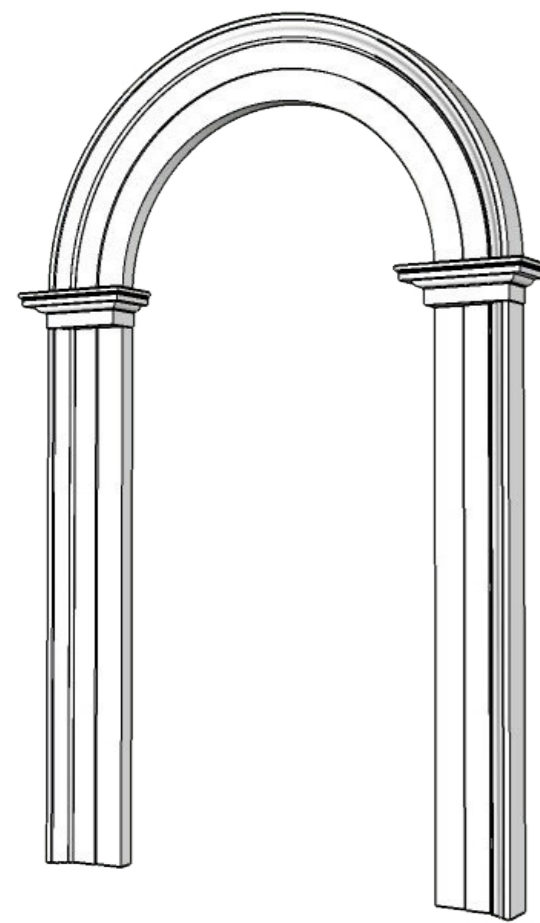

## CURVED DOOR & WINDOW SURROUNDS

---

LENGTH - 1750 mm

HEIGHT - 2875 mm



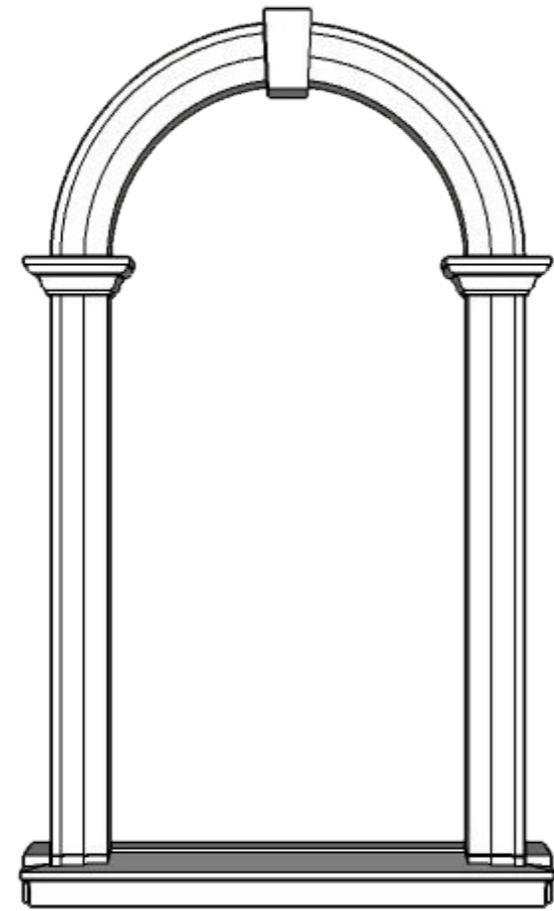

CURVED DOOR & WINDOW  
SURROUNDS WITH KEY STONE

LENGTH - 1750 mm

HEIGHT - 2925 mm



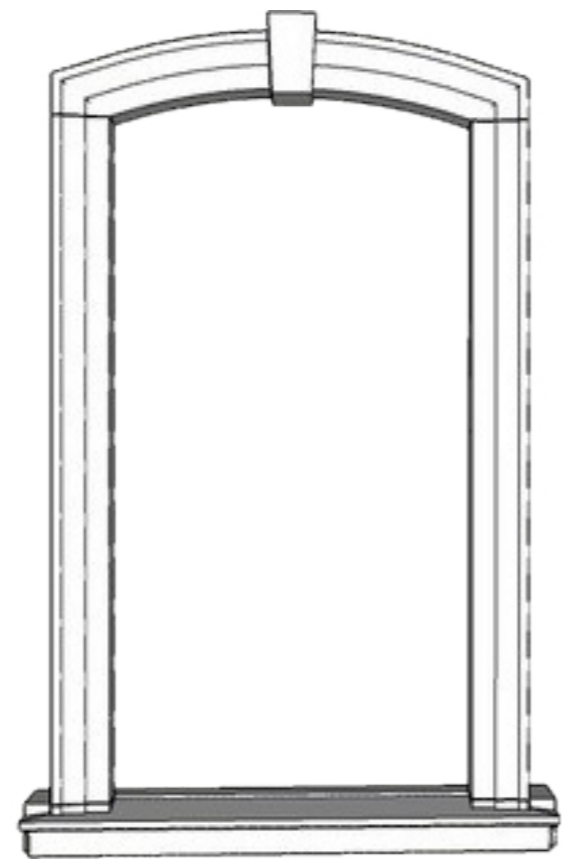

## CURVED DOOR & WINDOW SURROUNDS WITH KEY

LENGTH - 1320 mm

HEIGHT - 2050 mm



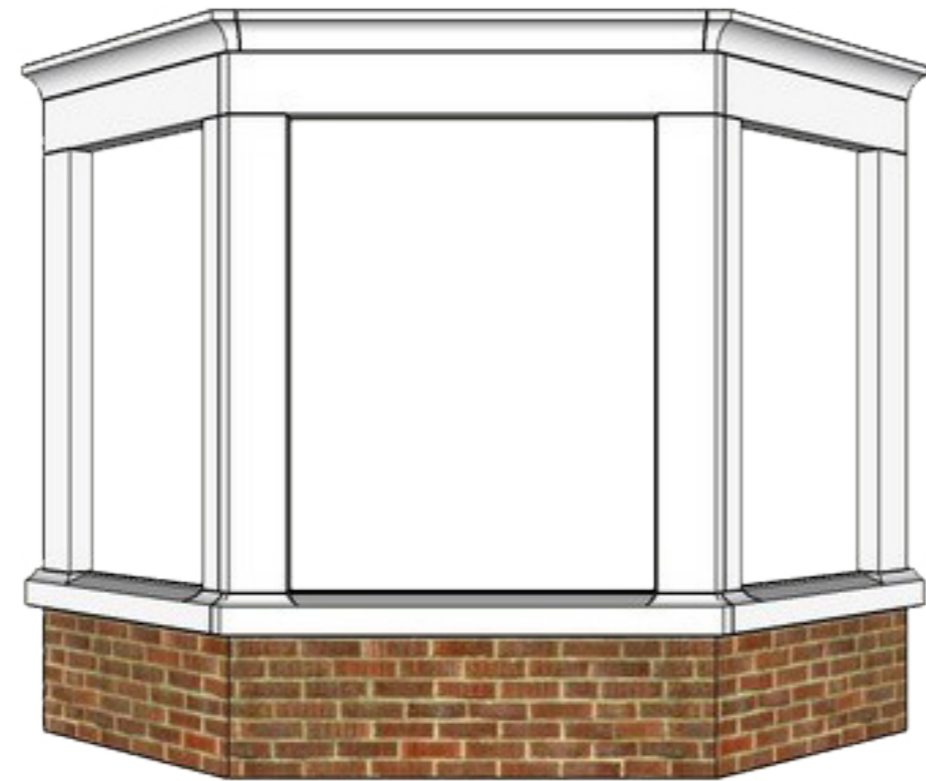

## BAY WINDOW SURROUNDS

LENGTH - 3500 mm

PROJECTION - 700 mm

HEIGHT - 2125 mm

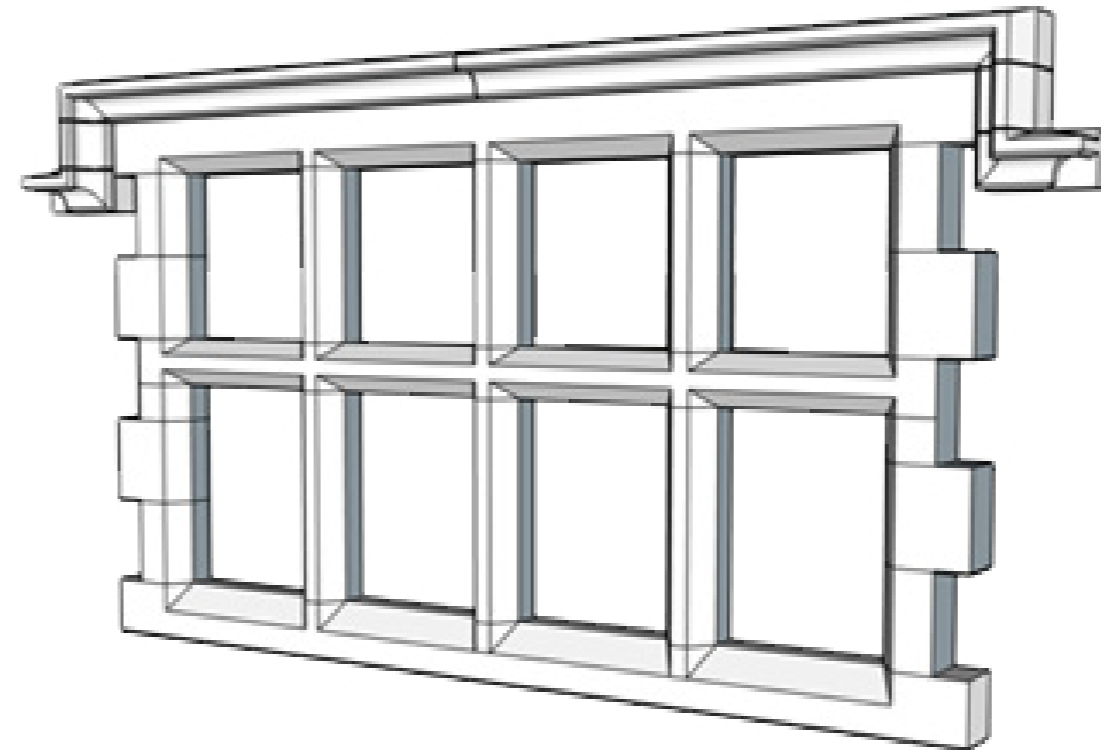

## MULLION WINDOW SURROUNDS

LENGTH - 2280 mm

HEIGHT - 1465 mm





# CONSERVATORIES & ORANGERIES

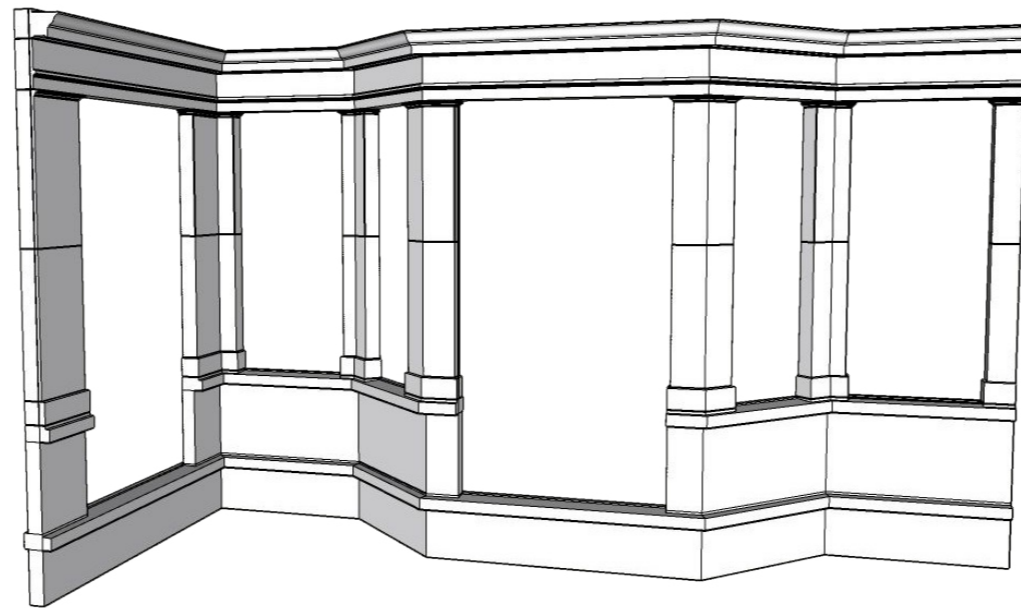

## CONSERVATORY SURROUND

LENGTH - 5900 mm

HEIGHT - 3900 mm





# WINDOW CILLS



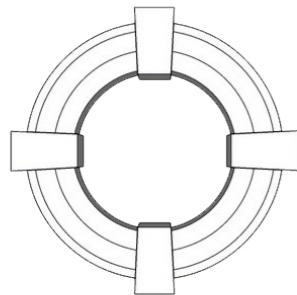

LENGTH - 760 mm

HEIGHT - 760 mm

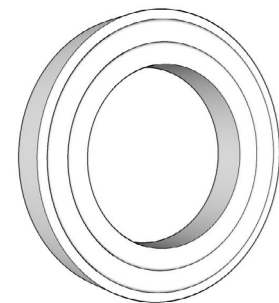

LENGTH - 760 mm

HEIGHT - 760 mm

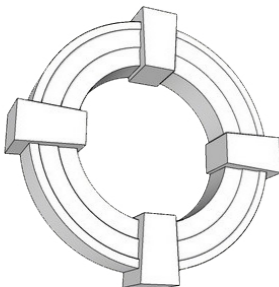

LENGTH - 860 mm

HEIGHT - 860 mm

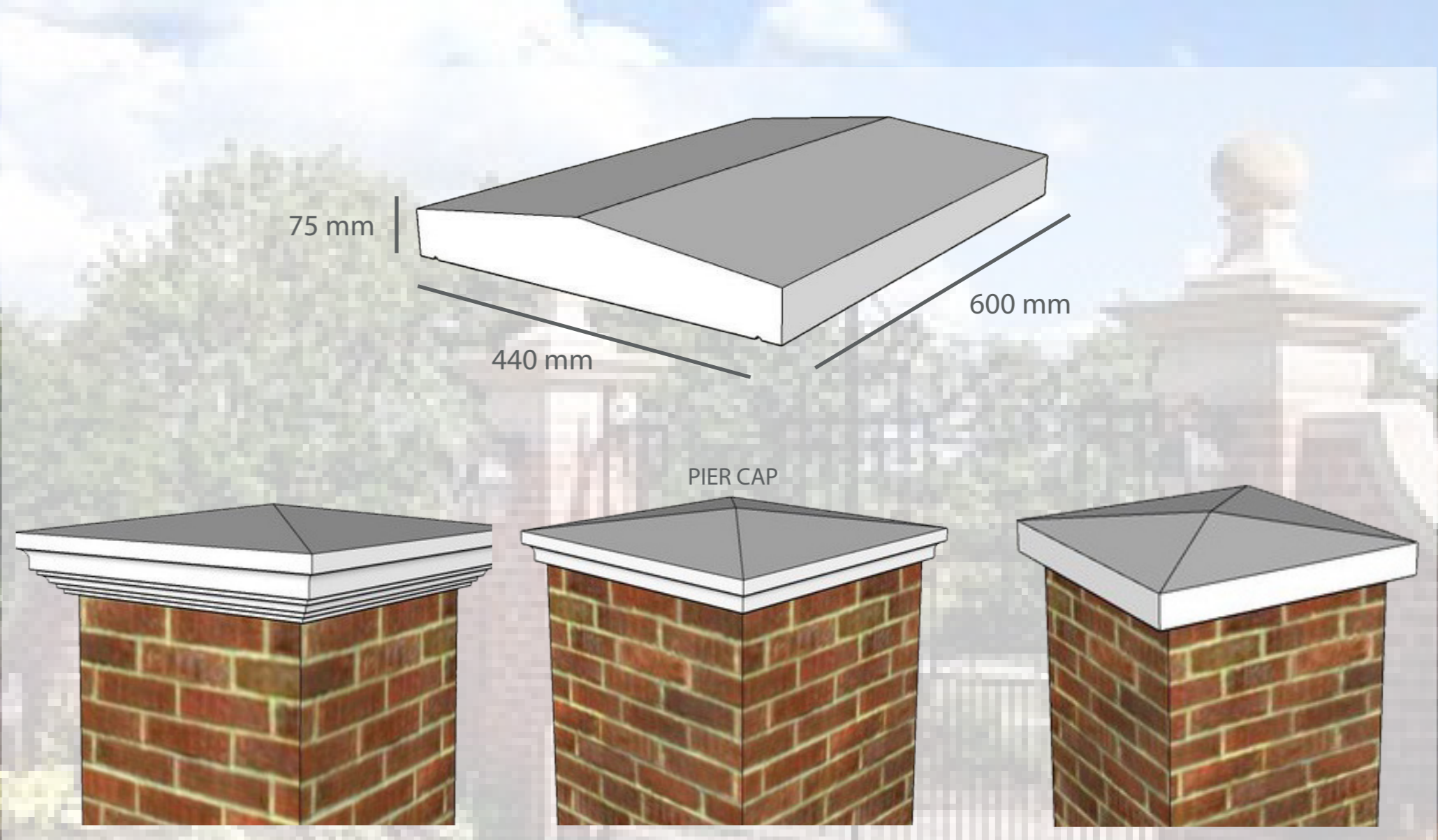

75 mm

440 mm

600 mm

PIER CAP

LENGTH - 687 mm

WIDTH - 687 mm

HEIGHT - 165 mm

LENGTH - 687 mm

WIDTH - 687 mm

HEIGHT - 120 mm

LENGTH - 650 mm

WIDTH - 650 mm

HEIGHT - 120 mm

CLASSICAL PIER &  
BALUSTRADE RUN

BALUSTRADE COPING

MOULDING

HEADS

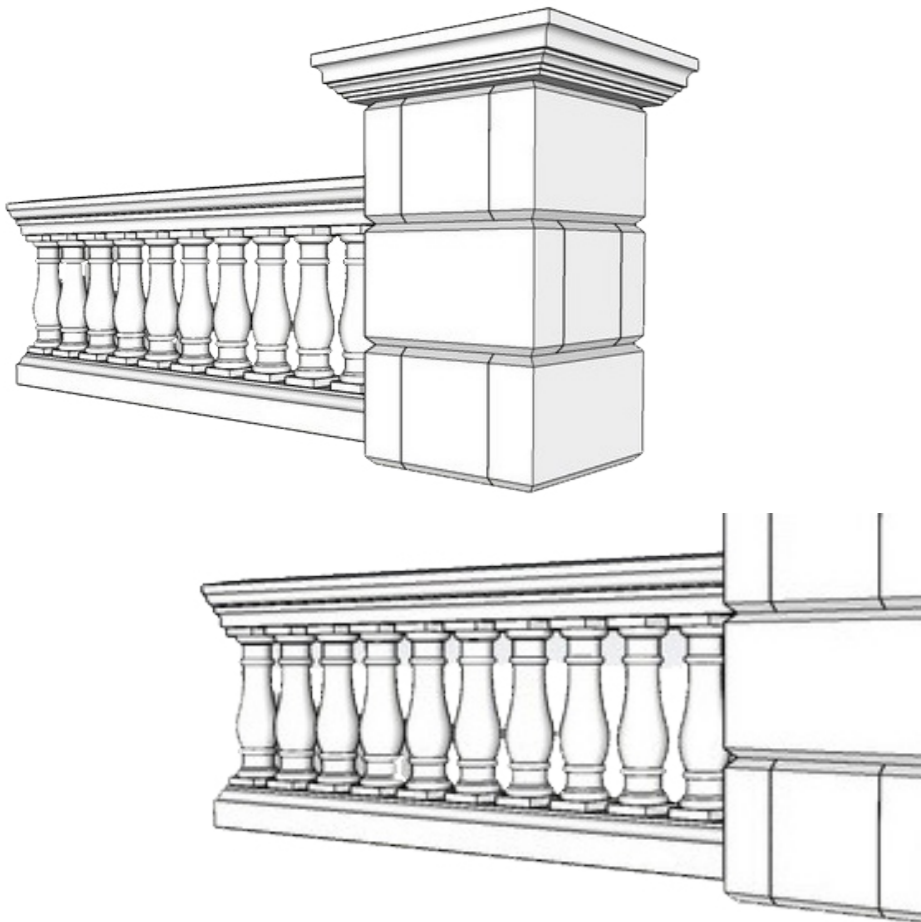

LENGTH - 500 mm  
WIDTH - 500 mm  
HEIGHT - 900 mm

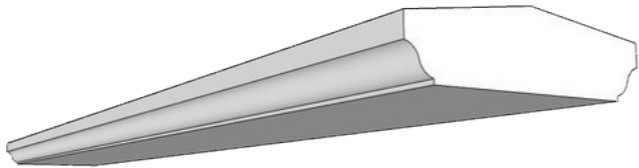

LENGTH - 2 Metres  
WIDTH - 280 mm  
HEIGHT - 140 mm

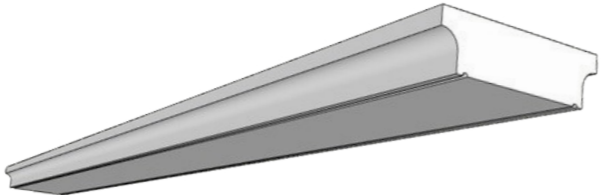

LENGTH - 2 Metres  
WIDTH - 280 mm  
HEIGHT - 140 mm

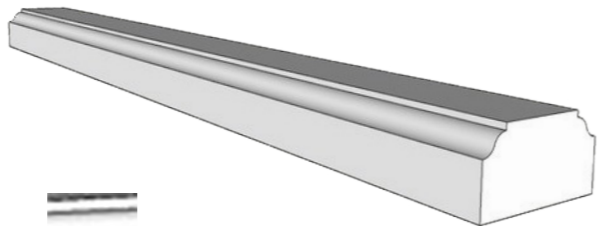

LENGTH - 2 Metres  
WIDTH - 220 mm  
HEIGHT - 120 mm



LENGTH - 120 mm  
WIDTH - 120 mm  
HEIGHT - 468 mm

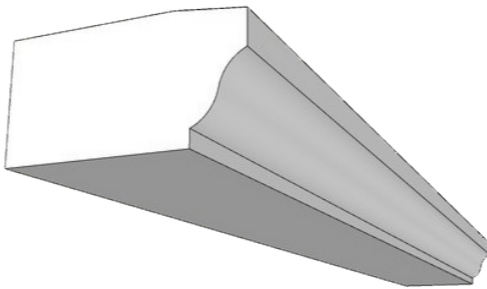

LENGTH - 1 Metre  
WIDTH - 140 mm  
HEIGHT - 72 mm

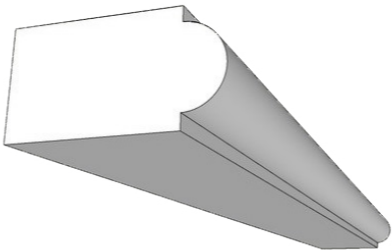

LENGTH - 1 Metre  
WIDTH - 136 mm  
HEIGHT - 72 mm

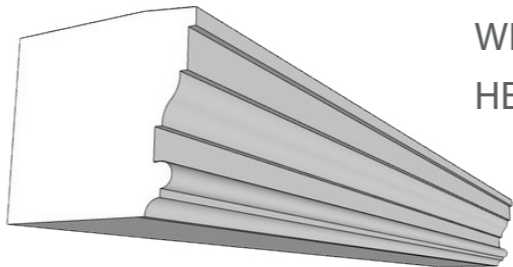

LENGTH - 1 Metre  
WIDTH - 136 mm  
HEIGHT - 120 mm

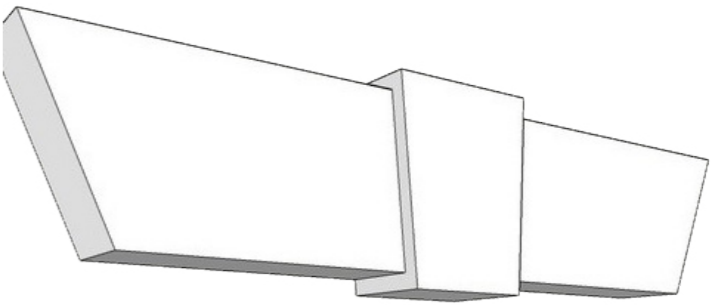

LENGTH - 1056 mm  
WIDTH - 120 mm  
HEIGHT - 255 mm

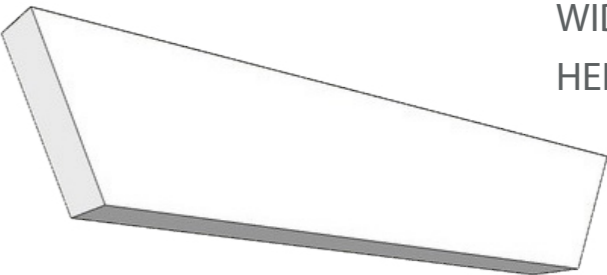

LENGTH - 1056 mm  
WIDTH - 100 mm  
HEIGHT - 215 mm

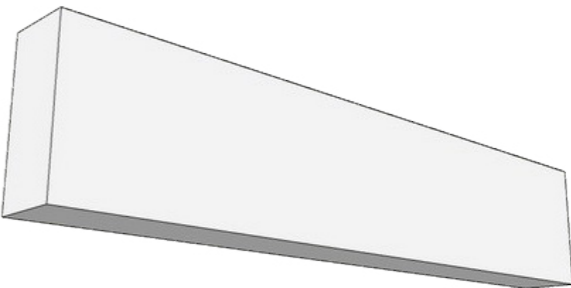

LENGTH - 1056 mm  
WIDTH - 100 mm  
HEIGHT - 215 mm

## PEDIMENTS

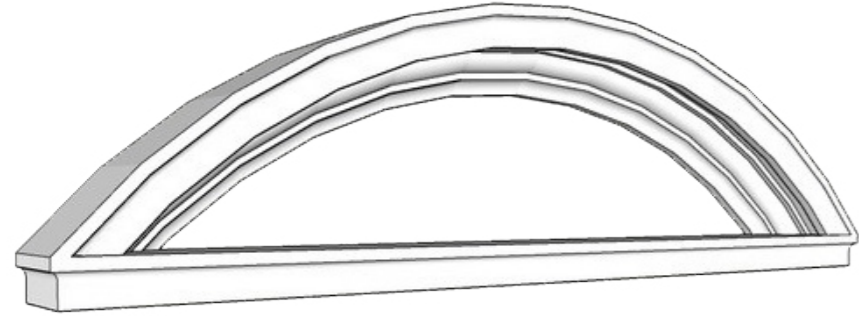

LENGTH - 1400 mm  
WIDTH - 120 mm  
HEIGHT - 375 mm

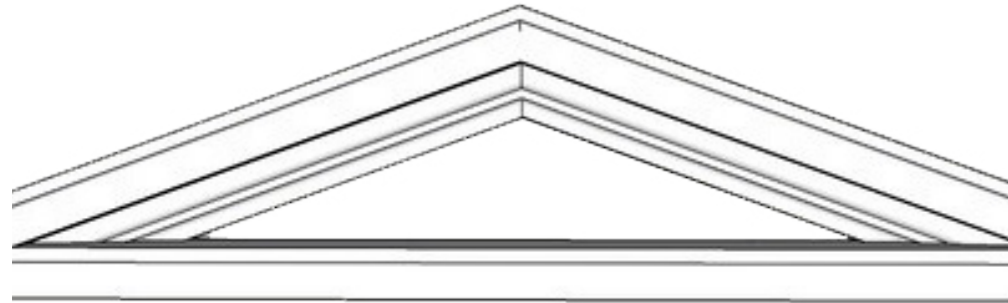

LENGTH - 1400 mm  
WIDTH - 120 mm  
HEIGHT - 310 mm

## CILL

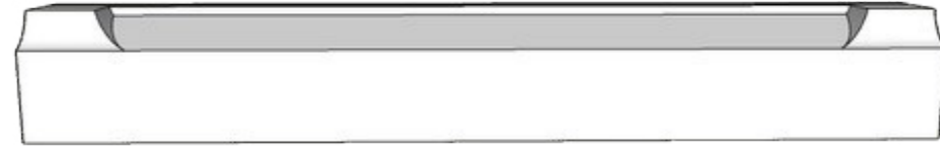

LENGTH - 1 Metre  
WIDTH - 150 mm  
HEIGHT - 140 mm

## DOOR OR WINDOW CORNICE MOULDING

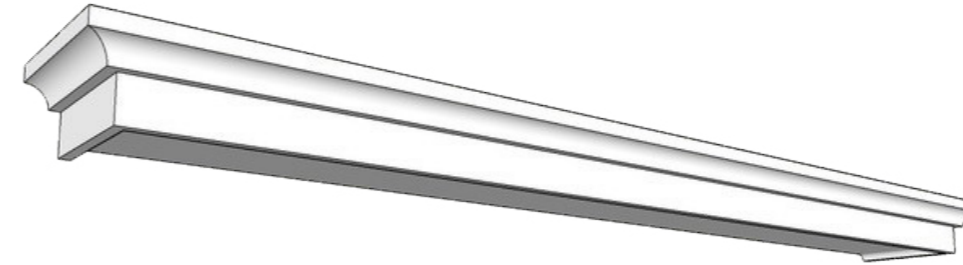

LENGTH - 1290 mm  
WIDTH - 175 mm  
HEIGHT - 80 mm

## CORNICE

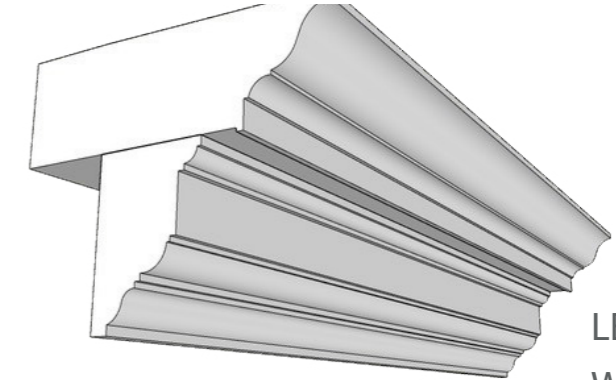

LENGTH - 1188 mm  
WIDTH - 353 mm  
HEIGHT - 300 mm

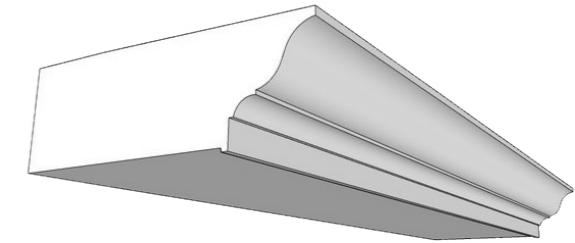

LENGTH - 1188 mm  
WIDTH - 353 mm  
HEIGHT - 120 mm

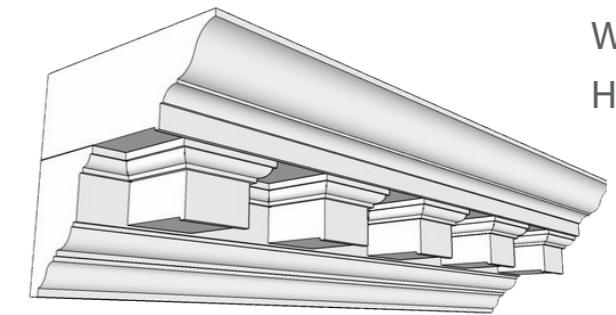

LENGTH - 2440  
WIDTH - 294 mm  
HEIGHT - 516 mm

# CONTEMPORARY



Ceco Stone is perfect for more innovative and creative architectural designs. This eco-friendly and cost effective material can be shaped into visually stunning air blocks, creating multiple opportunities for designing and constructing partition walls for open-plan living, office space and garden projects

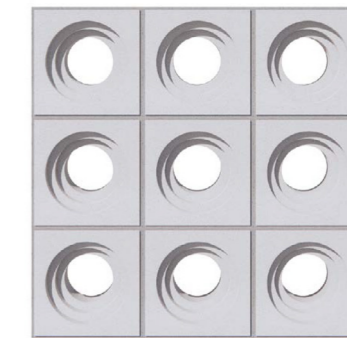
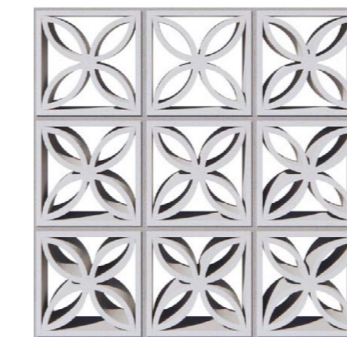
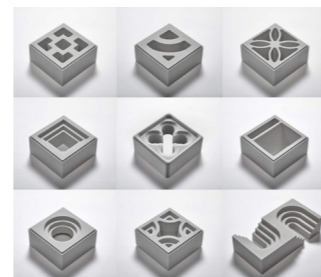

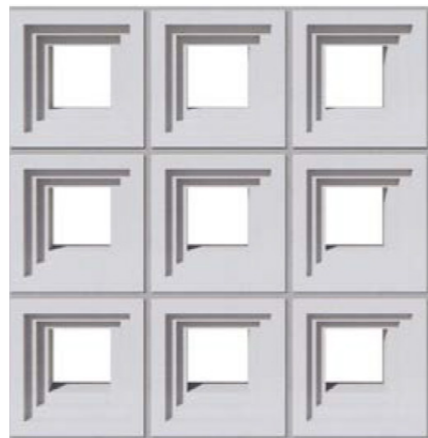
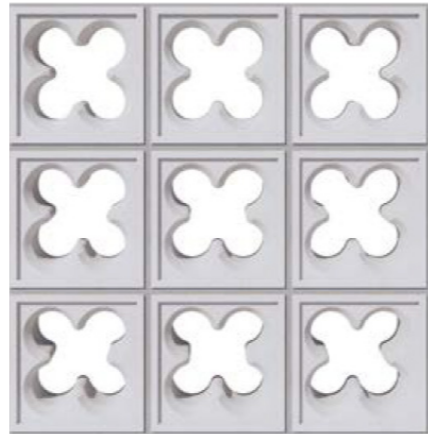

# INSTALLATION



The greatest saving with Ceco Stone is not perhaps in the unit price, but in the on-site installation time. Due to the lightweight and high strength nature of the product, large components can be handled by one operative. Ceco Stone has been designed to avoid the necessity for time consuming traditional mortar installation.



It can be jointed with tubes of grout mix and simply glued to the principle construction structure with approved high grab strength masonry glues. We recommend that straps are used additionally wherever possible to secure as firmly as possible.



Where components overlap, the operative can simply drill through and apply screws / anchor fixings / dowels into a wooden or brick/block backing structure.



## MECHANICAL FIXING

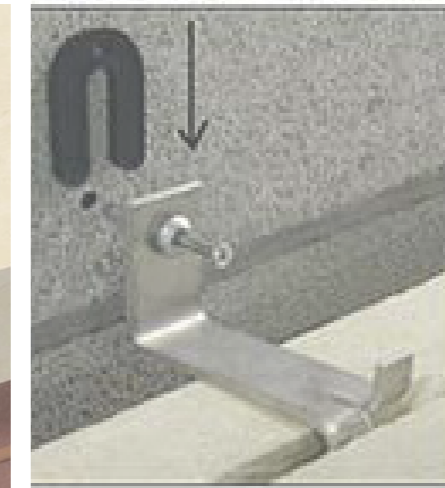



## OUR STORY

McMillan & Holder are a UK based company of Master Masons, who offer a passionate commitment to craftsmanship.

McMillan & Holder began as a small family-run business, and this is retained at the centre of our company's ethos. From the outset (in the early years) the desire was to produce quality architectural components for the restoration of historic buildings, and has resulted in years of preserving the bedrock of our historic Estates, Castles, Cottages and Cathedrals.

## TESTIMONIALS

"Impressed by their commitment to quality. Working with them has always been a pleasure."

Tim Ratcliffe - BA, DipArch, SPAB Lethaby Scholar, AABC.  
(Architect).

"Second to none, and the quality of their workmanship is superb. We would strongly recommend."

Tamara Pickstock, Pickstock Homes.

"Approachable, enthusiastic and committed to achieving an excellent result."

James Wade MA DipArch RIBA AABC for Arrol & Snell Ltd.

"Highest standards, top quality craftsmanship."

Rachael Freemantle BSc(Hons) PGDipCHE MRICS  
BCAS IHBC Conservation Accredited Chartered  
Building Surveyor. Senior Building Surveyor for  
National Trust.

Skill, craftsmanship and a professional approach. I would not hesitate for a second in recommending the team !

Sean Pemble RIBA.

"Superb. Excellent. I have no hesitation in recommending them."

Trevor Hewett RIBA.

ARROL & SNELL  
ARCHITECTURE - CONSERVATION

Pickstockhomes

RIBA



National  
Trust

## CONTACT US

For all further enquiries, please contact us:



+44 7817 890203  
+44 1694 245060



Info@mcmillanholder.com



Home Farm, Leebotwood,  
Shropshire, UK, SY6 6LX





# Ceco Stone

— Lightweight Recycled Architectural Components —

Home Farm, Leebotwood, Shropshire, UK, SY6 6LX

+44 7817 890203 +44 1694 245060